

# **DEFENDER 1000**

---

Product Manual

# IMPORTANT SAFETY INSTRUCTIONS



**READ AND UNDERSTAND ALL INSTRUCTIONS.** When using electric appliances, basic precautions should always be followed, including the following:

- ✓ The safety of this device complies with current safety regulations and with applicable directives.
- ✓ Please read these instructions carefully prior to using this product.
- ✓ There is a possible risk of personal injury if you fail to follow the advice laid out in this guide.
- ✓ After review, ensure these instructions are stored in a safe place for future reference.
- ✓ The shield light must not be modified in any way. Alterations of any description may invalidate the product warranty and technical approvals.
- ✓ Shield light must only be used for its intended purpose.
- ✓ Light emitted is extremely bright and can cause temporary or even permanent blindness.
- ✓ Always switch OFF and uninstall the batteries when not in use and prior to cleaning.
- ✓ Always ensure that the unit has cooled completely before storing it.
- ✓ Do not work near flammable gases or liquids.
- ✓ Make sure that you know how to switch this unit OFF before you switch it ON.



## Additional Safety Notes

**A Max operating ambient temperature is 120 F.**

**If operated at sustained temperatures above 120 F, the unit will be permanently damaged.**

1. The light set is not explosion-proof.
2. Uninstall the batteries from the unit before replacing them.
3. Do not install any other batteries besides non-standard ones.
4. Do not submerge the unit in any liquids.
5. Use standard rechargeable 18350 batteries. **CR123 batteries can be used.**

## INCLUDED ITEMS

---

- LED Shield Light Unit
- Battery Pack
- Pressure Switch
- Velcro

## REQUIRED ITEMS

---

- Cleaning Wipes
- Batteries 2x 18650 (Alternative: 4x CR123)

# PARTS REFERENCE

## LIGHT UNIT

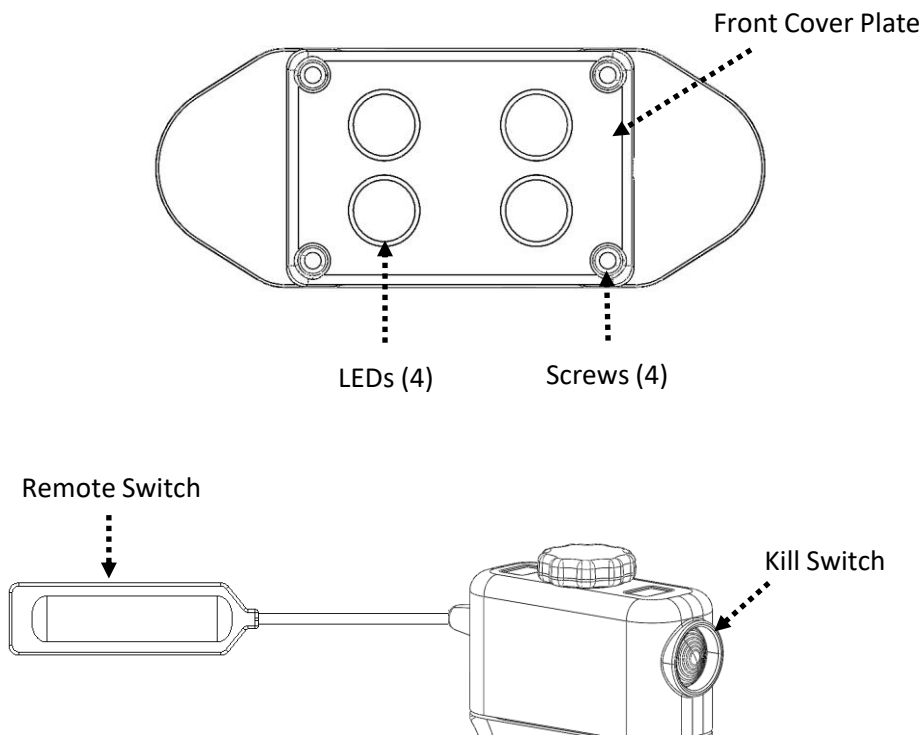

### Important Note

- Click on the **Kill Switch** to enable operation of the **Remote Switch**
- **Kill Switch** main function is to prevent accidental operation of the light

### Remote Switching Modes

Click the  
Remote Switch



ON



STROBE



OFF



# BATTERY INSTALLATION

---

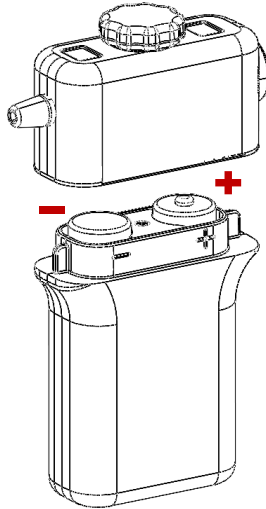

## 18650 Battery Installation (See Warning Below)

1. Unfasten the battery cap and Insert (2) 18650 batteries following the correct polarity (+.-)

**WARNING:** Always follow the battery manufacturer's instructions as to the proper usage, handling, storage, and disposal of batteries. Use only batteries from a reputable manufacturer. Do not mix brands or types of batteries in the same light. Replace all batteries at the same time. Failure to follow safety instructions may result in personal injury and damage to property.

Lithium-Ion batteries can present a fire, explosion, and burn hazards. Use only 18650 battery cells with a protection circuit. Remove the battery when the LED light is not in use.

# TECHNICAL SPECIFICATIONS

---

Lumens	1000 Lumens
Power Source	(2 x 18650) or (4 x CR123) batteries (not included)
Battery Life	5 Hours (18650 batteries) 2.5 Hours (CR123 batteries) *Exact duration will depend on the brand and capacity
Weight	0.52 lbs (238g)
LED Front Dimensions	5.0 x 1.9 x 0.5 in (127 x 50 x 12 mm)
Battery Pack Dimensions	2.3 x 1.5 x 4.4 in (60 x 39 x 112 mm)
Ingress Protection	IP54
Fire Resistant	Meets NFPA 1971 – 8.6 (2013) Requirements
Water Protection	IP54
Impact Resistant	9.8 ft (3 m)
LED Color Temperature	White - 5700K
Operating Temperature	-4 °F (-20 °C) ~ 104 °F (40 °C)
Beam Distance	890 ft ( 271 m)
Features	Lightweight & Compatible with all shields

# WARRANTY

---

## Warranty Statement:

Interlog Corp provides a 1-year limited warranty for the Defender 1000 shield light. We guarantee the product free from defects in materials and workmanship for a period of one (1) year from the date of purchase.

## Warranty Coverage:

During the warranty period, if the product exhibits any defects or malfunctions resulting from faulty materials or workmanship, we will, at our discretion, either repair or replace the product, free of charge.

## Exclusions and Limitations:

This limited warranty does not cover damages or defects resulting from:

1. Accidental damage, misuse, or abuse of the product.
2. Unauthorized modifications or repairs performed by third parties.
3. Failure to follow the products' instructions and guidelines.
4. Acts of nature or external factors beyond our control.

# CONTACT

---

### Interlog Corporation

1295 N. Knollwood Circle  
Anaheim, CA 92801

Phone: 714-529-7808

Email: [info@interlogcorp.com](mailto:info@interlogcorp.com)

Website: [www.interlogcorp.com](http://www.interlogcorp.com)

### JNI Armor (Master Distributor)

8402 Monroe Ave #4  
Stanton, CA 90680

Phone: 714-752-3562

Email: [sales@jniarmor.com](mailto:sales@jniarmor.com)

Website: [www.jniarmor.com](http://www.jniarmor.com)

